

## MP580W#PVS

- Suitable for Distribution Market
- Simple design embodies modern style
- Better energy generation performance
- High-quality module guarantees long-term reliability

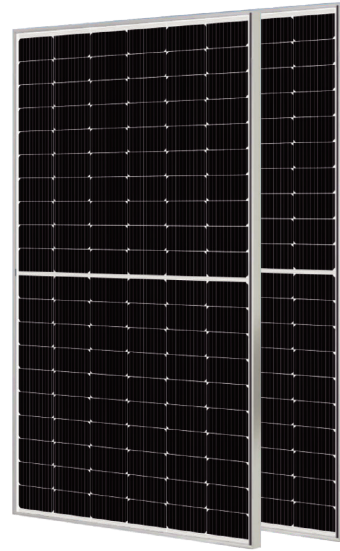

**22.6%**  
MAX MODULE  
EFFICIENCY

**0~3%**  
POWER  
TOLERANCE

**<1.5%**  
FIRST YEAR  
POWER DEGRADATION

**0.40%**  
YEAR 2-25  
POWER DEGRADATION

### Additional Value

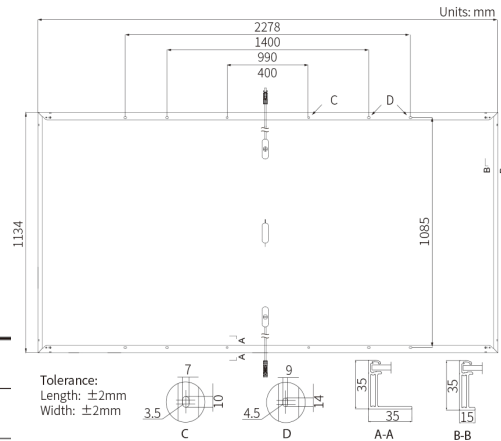
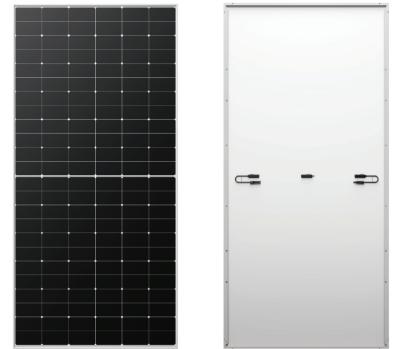
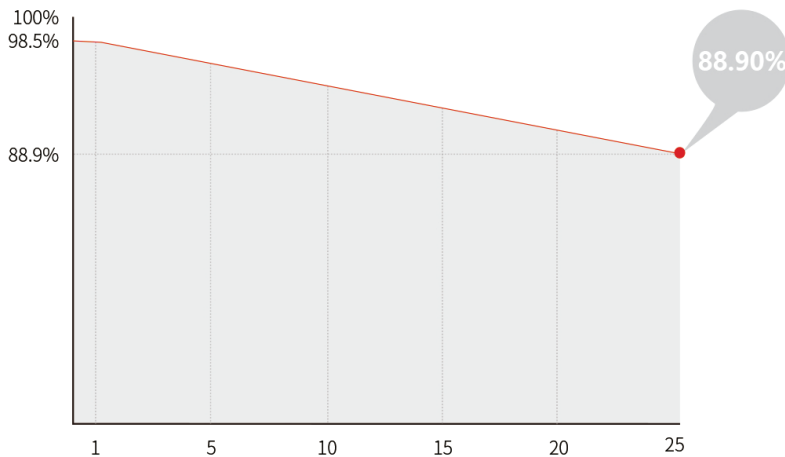

### Mechanical Parameters

Cell Orientation	144 (6×24)
Junction Box	IP68
Output Cable	4mm <sup>2</sup> , +400, -200mm/±1400mm length can be customized
Glass	Single glass, 3.2mm coated tempered glass
Frame	Anodized aluminum alloy frame
Weight	27.2kg
Dimension	2278 × 1134 × 30mm
Packaging	36pcs per pallet / 180pcs per 20' GP / 720pcs per 40' HC

LEAVE POWER FOR MEDAL POWER

## Electrical Characteristics

Module Type	MP580W#PVS	
Testing Condition	STC	NOCT
Maximum Power (Pmax/W)	580	433
Open Circuit Voltage (Voc/V)	52.21	49.02
Short Circuit Current (Isc/A)	14.20	11.47
Voltage at Maximum Power (Vmp/V)	44.06	40.20
Current at Maximum Power (Imp/A)	13.17	10.78
Module Efficiency(%)	22.5	

## Mechanical Parameters

Cell Orientation	144 (6×24)
Junction Box	IP68
Output Cable	4mm <sup>2</sup> , +400, -200mm/±1400mm length can be customized
Glass	Single glass, 3.2mm coated tempered glass
Frame	Anodized aluminum alloy frame
Weight	27.2kg
Dimension	2278×1134×30mm
Packaging	36pcs per pallet / 180pcs per 20' GP / 720pcs per 40' HC

## Mechanical Loading

Front Side Maximum Static Loading	5400Pa
Rear Side Maximum Static Loading	2400Pa
Hailstone Test	25mm Hailstone at the speed of 23m/s

## Temperature Ratings (STC)

Temperature Coefficient of Isc	+0.050%/°C
Temperature Coefficient of Voc	-0.230%/°C
Temperature Coefficient of Pmax	-0.290%/°C

LEAVE POWER FOR MEDAL POWER