

MP-121500-AGR

Features:



DC-MG (Deep Cycle GEL) series is hybrid GEL battery with 12 years floating design life ,it is ideal for standby or frequent cyclic discharge applications under extreme environments. By using strong grids, high purity lead and patented Gel electrolyte, the DC-MG series offers excellent recovery capability after deep discharge under frequent cyclic discharge use, and can deliver 450 cycles at 100% DOD. Suitable for solar & wind system, CATV, marine, RV and deep discharge UPS, and telecommunication, etc.

Specification

| | |
|------------------------------------|--|
| Cells Per Unit | 6 |
| Voltage Per Unit | 12 |
| Capacity | 150Ah@20hr-rate to 1.75V per cell @25°C |
| Weight | Approx. 40.5.0 Kg (Tolerance ± 3.0%) |
| Internal Resistance | Approx. 6.0 mΩ |
| Terminal | F5(M8)/F12 (M8) |
| Max. Discharge Current | 2600A (5 sec) |
| Design Life | 12 years (floating charge) |
| Max. Charging Current | 45.0 A |
| Reference Capacity | C3 114.6AH |
| | C5 129.0AH |
| | C10 143.0AH |
| | C20 150.0AH |
| Float Charging Voltage | 13.6 V~13.8 V @ 25°C Temperature Compensation: -3mV/°C/ Cell |
| Cycle Use Voltage | 14.6 V~14.8 V @ 25°C Temperature Compensation: -4mV/°C/ Cell |
| Operating Temperature Range | Discharge: -20°C~60°C |
| | Charge: 0°C~50°C |
| | Storage: -20°C~60°C |
| Normal Operating Temperature Range | 25°C ± 5°C |
| Self Discharge | Valve Regulated Lead Acid (VRLA) batteries can be stored for up to 6 months at 25°C and then recharging is recommended. Monthly Self-discharge ratio is less than 3% at 25°C. Please charged batteries before using. |
| Container Materia | A.B.S. UL94-HB, UL94-V0 Optional. |

Dimensions

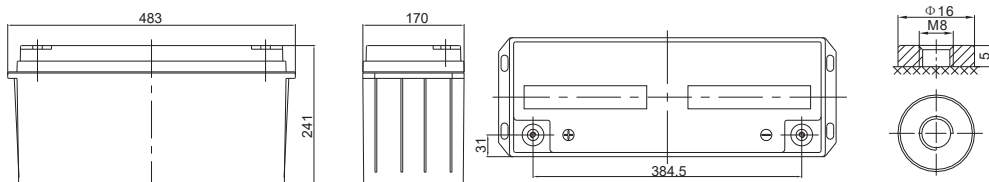

| | |
|--------------|-----------------------|
| Length | 483±2mm (19.0 inches) |
| Width | 170±2mm (6.69 inches) |
| Height | 241±2mm (9.49 inches) |
| Total Height | 241±2mm (9.49 inches) |
| Terminal | Value |
| M5 | 6~7 N*m |
| M6 | 8~10 N*m |
| M8 | 10~12 N*m |

F 12 Terminal

Unit: mm

LEAVE POWER FOR MEDAL POWER

LEAVE POWER FOR MEDAL POWER

Constant Current Discharge Characteristics : A(25°C)

| F.V/Time | 10MIN | 15MIN | 30MIN | 1HR | 2HR | 3HR | 4HR | 5HR | 8HR | 10HR | 20HR |
|----------|-------|-------|-------|------|------|------|------|------|------|------|------|
| 1.60V | 314.7 | 255.1 | 160.1 | 91.1 | 54.3 | 42.3 | 33.2 | 28.2 | 18.1 | 15.0 | 7.77 |
| 1.65V | 289.9 | 238.6 | 151.7 | 88.0 | 52.4 | 41.0 | 32.2 | 27.3 | 17.9 | 14.9 | 7.73 |
| 1.70V | 268.7 | 224.4 | 143.8 | 85.2 | 51.0 | 39.2 | 31.2 | 26.6 | 17.7 | 14.6 | 7.64 |
| 1.75V | 246.5 | 210.1 | 138.1 | 82.5 | 49.1 | 38.2 | 30.3 | 25.8 | 17.4 | 14.4 | 7.50 |
| 1.80V | 224.3 | 192.4 | 133.0 | 78.8 | 47.4 | 37.5 | 29.6 | 25.5 | 17.1 | 14.3 | 7.43 |
| 1.85V | 175.5 | 159.2 | 112.8 | 70.4 | 43.3 | 34.9 | 27.8 | 23.5 | 16.1 | 13.4 | 7.36 |

Constant Power Discharge Characteristics : WPC(25°C)

| F.V/Time | 10MIN | 15MIN | 30MIN | 1HR | 2HR | 3HR | 4HR | 5HR | 8HR | 10HR | 20HR |
|----------|-------|-------|-------|-------|-------|------|------|------|------|------|------|
| 1.60V | 535.8 | 445.0 | 290.9 | 171.0 | 102.6 | 80.2 | 63.9 | 53.4 | 35.2 | 29.4 | 15.5 |
| 1.65V | 516.0 | 432.7 | 284.1 | 168.1 | 99.8 | 78.2 | 62.3 | 51.9 | 35.0 | 29.1 | 15.4 |
| 1.70V | 481.6 | 409.6 | 270.4 | 163.2 | 97.3 | 75.2 | 60.4 | 50.6 | 34.5 | 28.6 | 15.2 |
| 1.75V | 448.1 | 386.6 | 261.0 | 158.7 | 93.9 | 73.4 | 58.9 | 49.5 | 34.0 | 28.3 | 15.0 |
| 1.80V | 412.9 | 357.3 | 252.5 | 152.2 | 91.7 | 73.0 | 57.8 | 48.8 | 33.4 | 28.0 | 14.8 |
| 1.85V | 327.5 | 300.2 | 216.6 | 136.7 | 84.5 | 68.1 | 54.4 | 45.2 | 31.6 | 26.4 | 14.7 |

